

CHARNIERES EN LAITON POLI

DESCRIPTION	H X L	CODE
<u>Charnière 100</u> laiton poli	50 x 40 mm	1300-0850

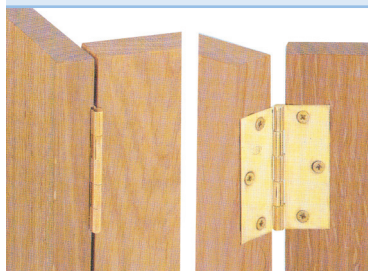

CHARNIERES EN LAITON NATURE

DESCRIPTION	EXÉCUTION	CODE	
<p>A technical drawing of a natural brass hinge. It consists of two vertical plates, each with three circular bolt holes. The plates are connected by a central horizontal bar. The width of the plates is labeled 'L' and the height is labeled 'H'.</p>	25 x 25 mm	laiton	1392-2525
	30 x 30 mm	laiton	1392-3030
	35 x 30 mm	laiton	1392-3530
	40 x 30 mm	laiton	1392-4030
	50 x 30 mm	laiton	1392-5030
	50 x 40 mm	laiton	1392-5040
	60 x 40 mm	laiton	1392-6040
	60 x 50 mm	laiton	1392-6050
	70 x 55 mm	laiton	1392-7055
	50 x 40 mm	bronzé	1392-5140
60 x 40 mm	bronzé	1392-6140	
60 x 50 mm	bronzé	1392-6150	
50 x 40 mm	nickelé	1392-5740	



CHARNIÈRES EN LAITON RÉGLABLE

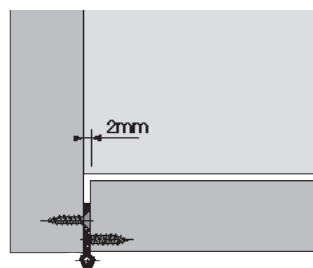

Charnière en laiton, réglable sur 2 dimensions

Hauteur:  $\pm 1$  mm  
Profondeur:  $\pm 1,5$  mm

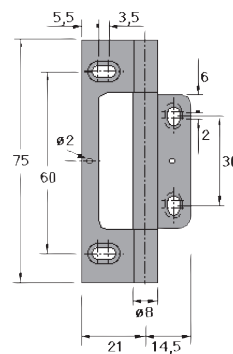
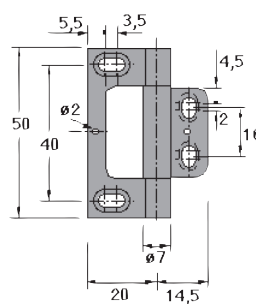

DESCRIPTION	EXÉCUTION	CODE
<u>50 mm</u> sans tête vase	nickelé mat	1300-1650
<u>75 mm</u> sans tête vase	nickelé mat	1300-1675